

DIN 1440 / DIN 1441

DIN 1440

~ ISO 8738

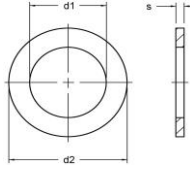

Podložna pločica za svornjake
Washers for clevis pins
Scheiben für Bolzen

DIN 1441

~ ISO 8738

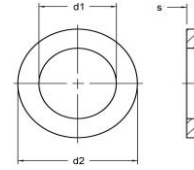

Fe						Zn					
d1	d2	s	N			d1	d2	s	N		
3	6	0,8	3	o	o	5,5	10	0,8	5	o	o
4	8	0,8	4	o	o	7,0	12	1,6	6	o	o
5	10	0,8	5	o	o	9,0	16	2,0	8	o	o
6	12	1,6	6	o	o	11,0	20	2,5	10	o	o
8	16	2,0	8	o	o	13,0	25	3,0	12	o	o
10	20	2,5	10	o	o	15,0	28	3,0	14	o	o
12	25	3,0	12	o	o	17,0	28	3,0	16	o	o
14	28	3,0	14	o	o	19,0	30	4,0	18	o	o
16	28	3,0	16	o	o	21,0	32	4,0	20	o	o
18	30	4,0	18	o	o	23,0	34	4,0	22	o	o
20	32	4,0	20	o	o	26,0	40	4,0	25	o	o
22	34	4,0	22	o	o	29,0	42	5,0	28	o	o
23	36	4,0	23	o	o	31,0	45	5,0	30	o	o
25	40	4,0	25	o	o	34,0	50	5,0	32	o	o
26	40	5,0	26	o	o	37,0	52	6,0	35	o	o
28	42	5,0	28	o	o	41,0	58	6,0	40	o	o
30	45	5,0	30	o	o	46,0	62	7,0	45	o	o
32	50	5,0	32	o	o	51,0	68	8,0	50	o	o
35	52	6,0	35	o	o	56,0	75	9,0	55	o	o
40	58	6,0	40	o	o	62,0	80	9,0	60	o	o
45	62	7,0	45	o	o						
50	68	8,0	50	o	o						
55	75	9,0	55	o	o						
60	80	9,0	60	o	o						

