

DIN 434 / DIN 440 R / DIN 440 V

DIN 434

~ HRN M.B2.032
~ UNI 6598

Kosa podloška za U-nosače
Square taper washers for U-sections
Scheiben vierkant, für U-Träger

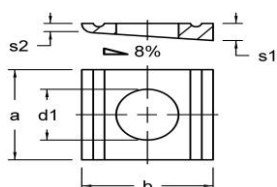

DIN 440 R

~ HRN M.B2.021
~ ISO 7094 R

Podložna pločica za drvene konstrukcije
Washers for wood constructions
Scheiben vorwiegend für Holzkonstruktionen

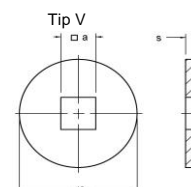
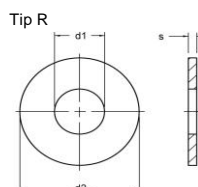

Fe Zn TZn

Fe Zn

Fe Zn

N	d1	a	b	s1	s2				N	d1	d2	s			N	a		
M 8	9,0	22,0	22,0	3,8	2,0	o	o	o	M 5	5,5	18,0	2,0	o	o	M 5	5,5	o	o
M 10	11,0	22,0	22,0	3,8	2,0	o	o	o	M 6	6,6	22,0	2,0	o	o	M 6	6,6	o	o
M 12	14,0	26,0	30,0	4,9	2,5	o	o	o	M 8	9,0	28,0	3,0	o	o	M 8	9,0	o	o
M 14	16,0	30,0	33,0	5,4	2,8	o	o	o	M 10	11,0	34,0	3,0	o	o	M 10	11,0	o	o
M 16	18,0	32,0	36,0	5,9	3,0	o	o	o	M 12	13,5	44,0	4,0	o	o	M 12	14,0	o	o
M 18	20,0	36,0	40,0	6,5	3,3	o	o	o	M 14				o	o				
M 20	22,0	40,0	44,0	7,0	3,5	o	o	o	M 16	17,5	56,0	5,0	o	o				
M 22	24,0	44,0	50,0	8,0	4,0	o	o	o	M 20	22,0	72,0	6,0	o	o				
M 24	26,0	56,0	56,0	8,5	4,0	o	o	o	M 24	26,0	85,0	6,0	o	o				
M 27	30,0	56,0	56,0	8,5	4,0	o	o	o										
M 30	33,0	62,0	62,0	9,0	4,0	o	o	o										

